

solista maxi

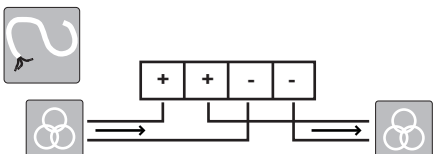

(i) Earth screen must be continuous along entire length of loop.
 (i) Option: l'ensemble du câble peut être protégé par écran.

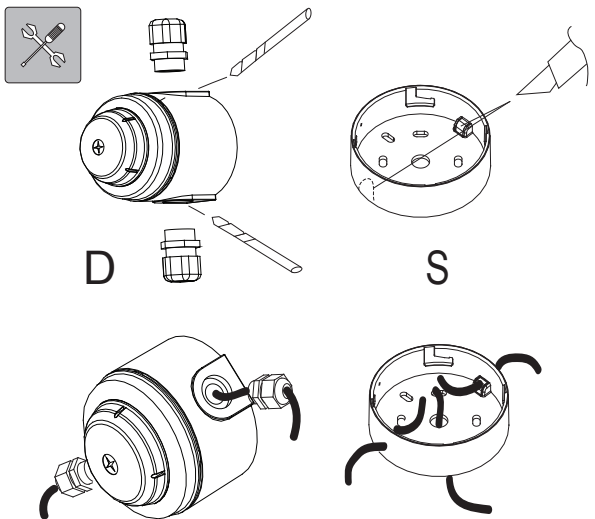
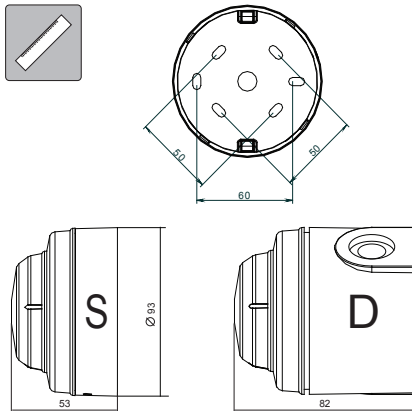
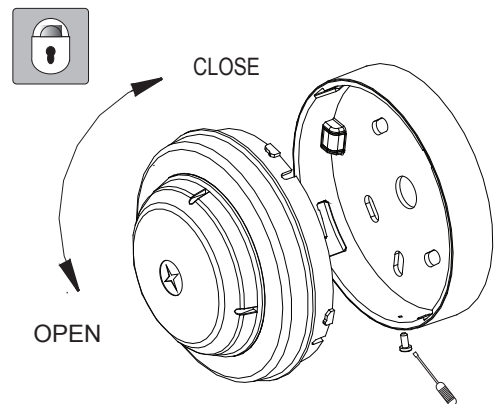

Care should be taken to ensure the cable does not put stress on the circuit board.
 Veuillez vous assurer que le câble ne crée pas de pression sur le circuit imprimé.

Switches settings / Interrupteurs

	1	2	3	4
Flash rate	Continuous	0	0	
	1Flash	1	1	
	2Flash	0	1	
Current setting	Low			1 1
	Medium			0 1
	High			1 0

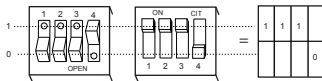

V	9 ~ 60VDC												
	Start-up current: < 22mA Courant de démarrage: < 22mA												
		Continuous			Single Flash			Double Flash					
		Low 0011	Med 0001	High 0000	Low 0011	Med 0001	High 0000	Low 0011	Med 0001	High 0000			
Red	12V	3mA	4mA	10mA	5mA	8mA	13mA	5mA	8mA	14mA			
	24V	3mA	5mA	9mA	5mA	5mA	11mA	3mA	5mA	12mA			
	48V	4mA	6mA	10mA	3mA	4mA	10mA	3mA	6mA	8mA			
Green	12V	3mA	4mA	10mA	5mA	8mA	13mA	5mA	8mA	14mA			
	24V	3mA	5mA	9mA	5mA	5mA	11mA	3mA	5mA	12mA			
	48V	4mA	6mA	10mA	3mA	4mA	10mA	3mA	6mA	8mA			
Amber	12V	3mA	4mA	10mA	5mA	8mA	13mA	5mA	8mA	14mA			
	24V	3mA	5mA	9mA	5mA	5mA	11mA	3mA	5mA	12mA			
	48V	4mA	6mA	10mA	3mA	4mA	10mA	3mA	6mA	8mA			
White	12V	3mA	4mA	10mA	5mA	8mA	13mA	5mA	8mA	14mA			
	24V	3mA	5mA	9mA	5mA	5mA	11mA	3mA	5mA	12mA			
	48V	4mA	6mA	10mA	3mA	4mA	10mA	3mA	6mA	8mA			
Blue	12V	3mA	5mA	15mA	6mA	12mA	15mA	5mA	10mA	10mA			
	24V	3mA	5mA	12mA	4mA	9mA	21mA	3mA	9mA	7mA			
	48V	4mA	6mA	12mA	5mA	7mA	12mA	3mA	5mA	7mA			
		2		2									
		0.5mm ~ 2.5mm											
		-10°C ~ +55°C											
		FR ABS & Polycarbonate Translucent											
		S IP 21C			D IP 65								
		1 Hz											

WARNING: Do NOT use high voltage testers if ANY equipment is connected to the system.
 ATTENTION: Ne PAS utiliser de testeurs haute tension lorsqu'un équipement est connecté au système.

Fulleon Ltd, Llantarnam Park, Cwmbarn, NP44 3AW
 www.fulleon.com
 25-8289-E



Supplied Format

Electronic Data

File Name : 25-8289-E

Text Pages

No. of Text Pages : 1
 Print Colours : 1
 Paper Spec : Stock White 70gsm

Finished Manual / Leaflet

Type of Binding : None
 Hole Punching : None
 Shrink Wrapping : None
 Folding Details : See below
 Final Dimensions :

- A5 (148.5x210mm) Single Sided
- A5 (148.5x210mm) Double Sided
- A4 (297x210mm) Single Sided
- A4 (297x210mm) Double Sided

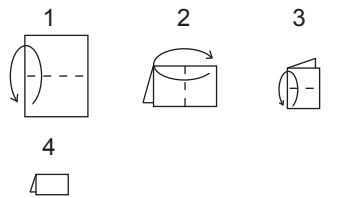

Manual Details

Part No.	25-8289-E
Description	Leaflet
Model	
Date	06/04/11
Issue No.	E

Approvals

Originated	G. Haack
Checked	
Approved	

